

Little Giant®

Ladder Systems

LOCK TAB REPLACEMENT

READ THESE INSTRUCTIONS COMPLETELY BEFORE YOU START. IF YOU DON'T UNDERSTAND THESE INSTRUCTIONS, PLEASE CALL 800-453-1192 FOR ASSISTANCE

1. Failure to comply with all instructions may result in serious injury.
2. Make sure this kit is compatible with your ladder. Before installing this kit, identify all kit components. If any components are missing, damaged or if you have any questions concerning the use of this kit on Little Giant Ladder Systems® products, please contact our Customer Experience Team at 800-453-1192. Do not substitute any components.
3. Inspect the ladder before installing this kit. Repair or replace any damaged or missing parts before using the ladder. Use only Little Giant Ladder Systems® replacement parts. If you are unable to repair it, discard the ladder.

COMPONENTS INCLUDED



TOOLS REQUIRED



NOTE: IF ANY OTHER PART OF THE LADDER IS DAMAGED BEFORE OR DURING THE PROCESS OF INSTALLING AND/OR REPAIRING, Please contact our customer experience team for assistance at 800-453-1192.
DO NOT USE A DAMAGED LADDER!

BREAKDOWN

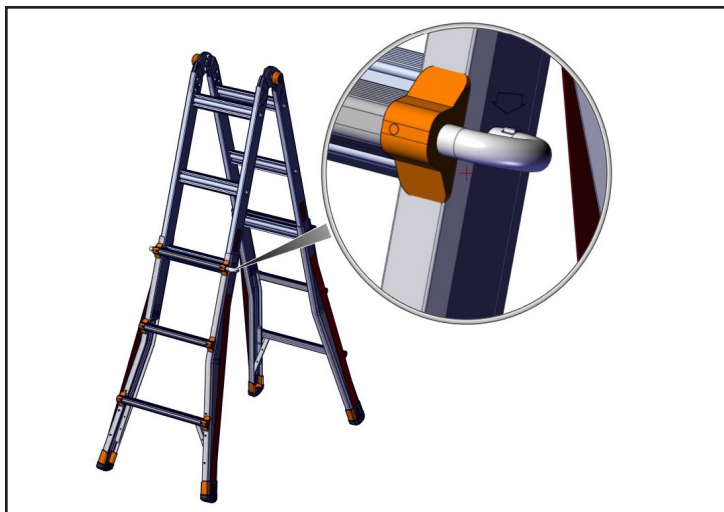
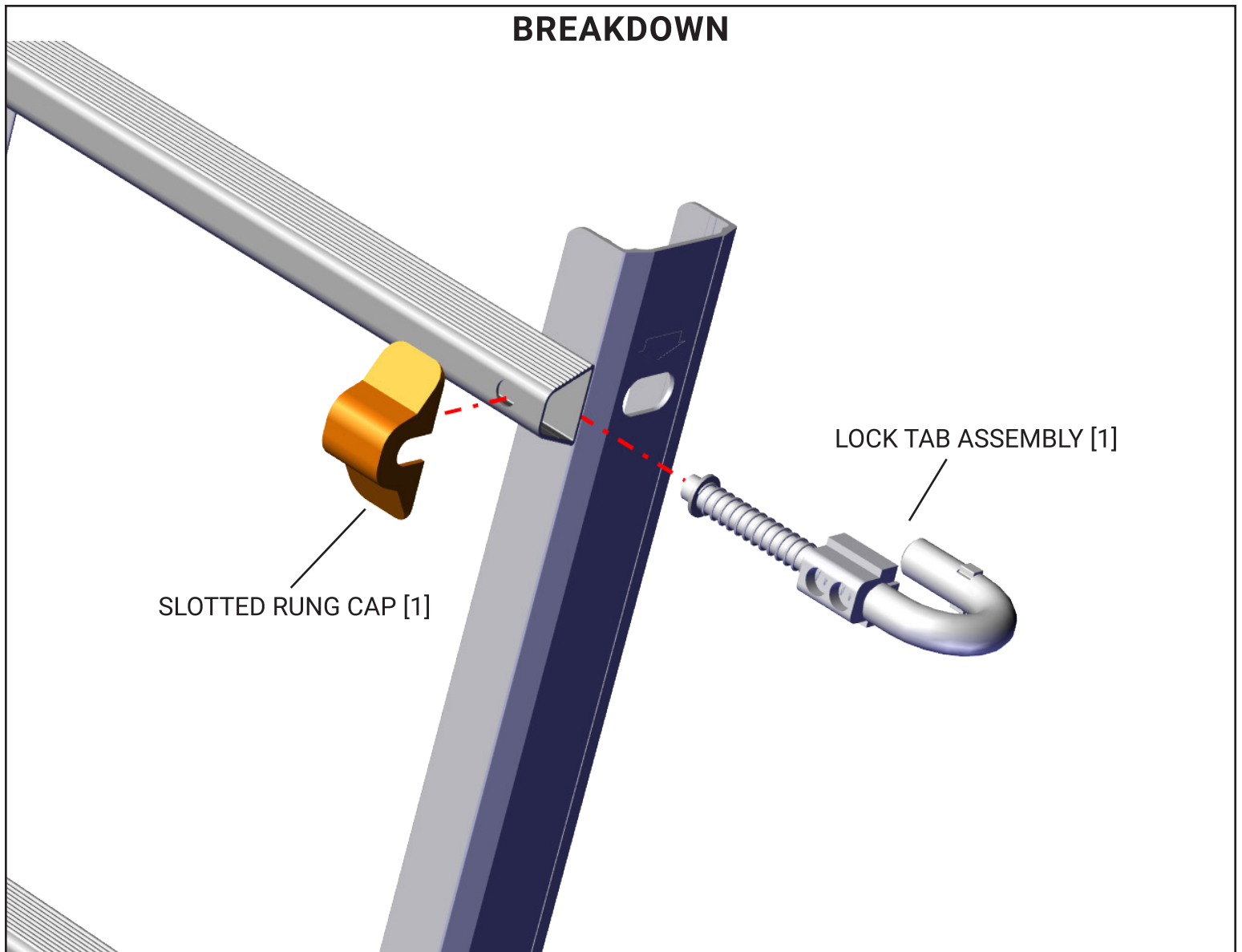

1. Locate the lock tab on the outer assembly that needs to be replaced.



2. Remove the outer assembly from the inner assembly.

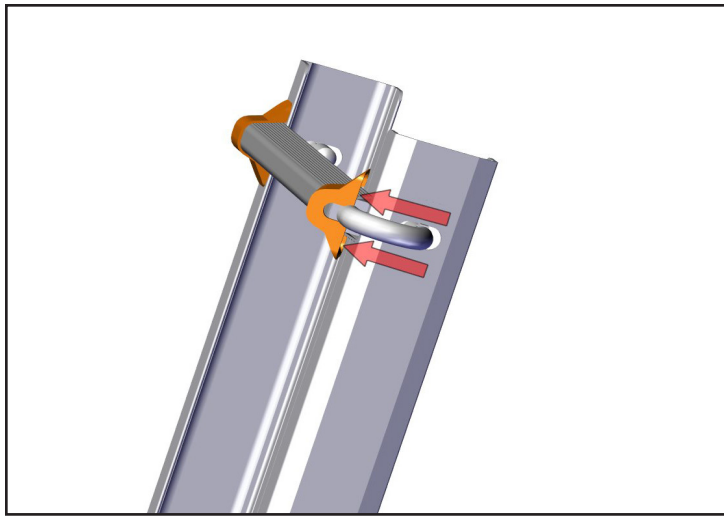

3. Lift the rung cap off the rung. *If unable to do so see step 5.

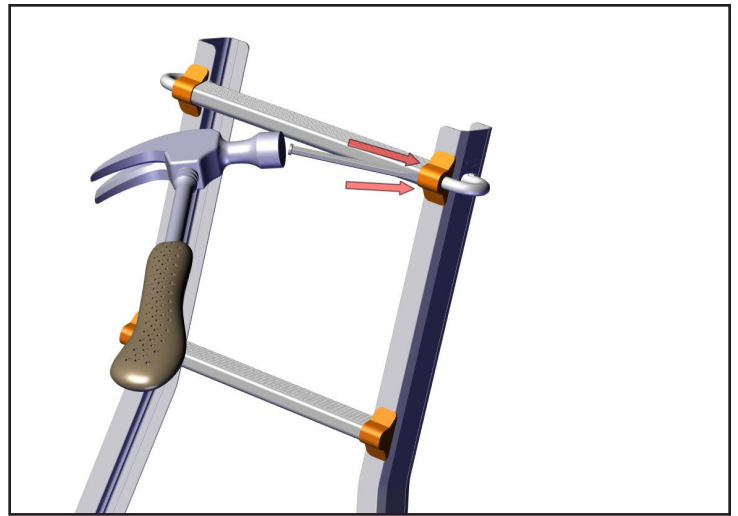

4. With chisel and hammer, tap the rung cap free of the rung making sure the chisel is parallel to the rung as not to damage the rung (as shown in illustration). Discard the damaged rung cap.

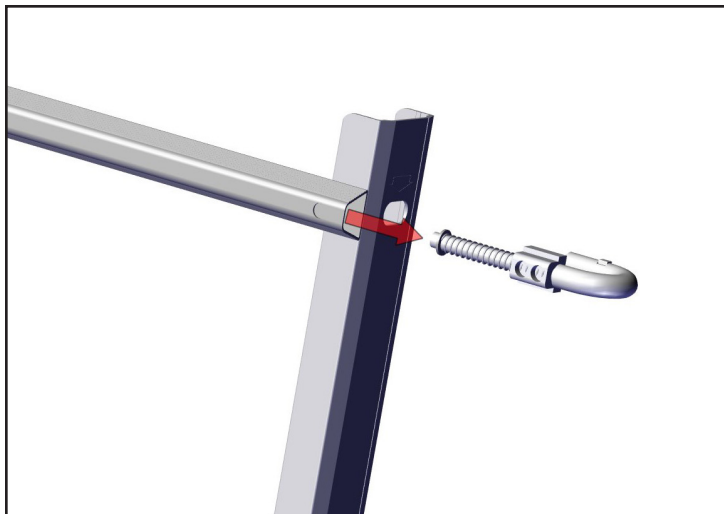

5. Pull the lock tab free of the rung, and discard.

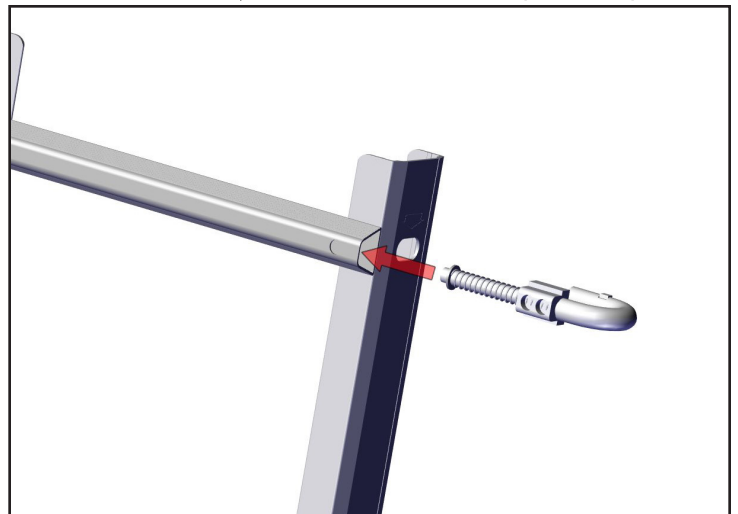

6. Insert the new lock tab (included in kit) into the rung.

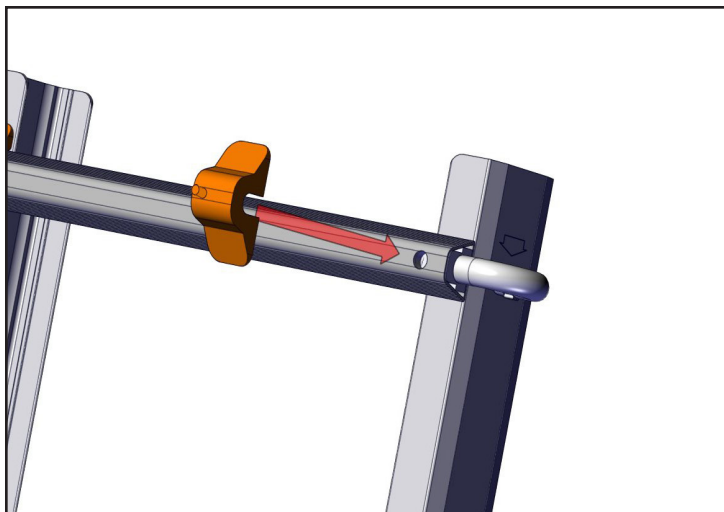

7. Push down slotted rung cap onto the lock tab. Line up the post with the hole in the rung.

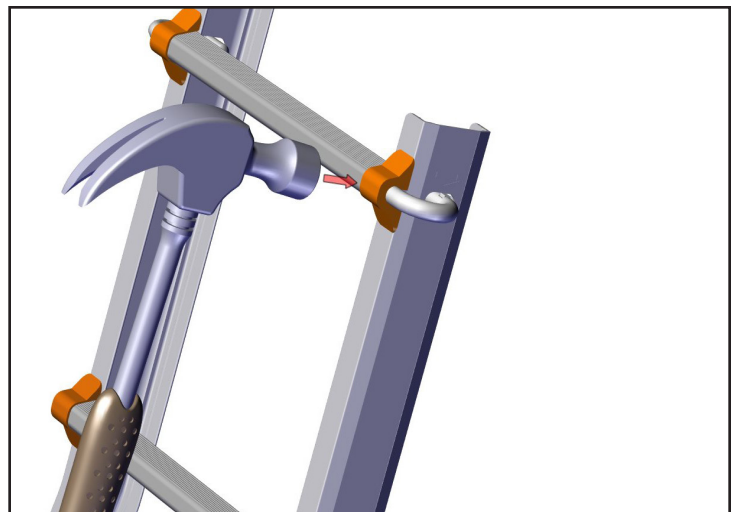

8. Use a hammer to tap the post on the rung cap into the rung hole. TAKE CARE NOT TO DENT RUNG.

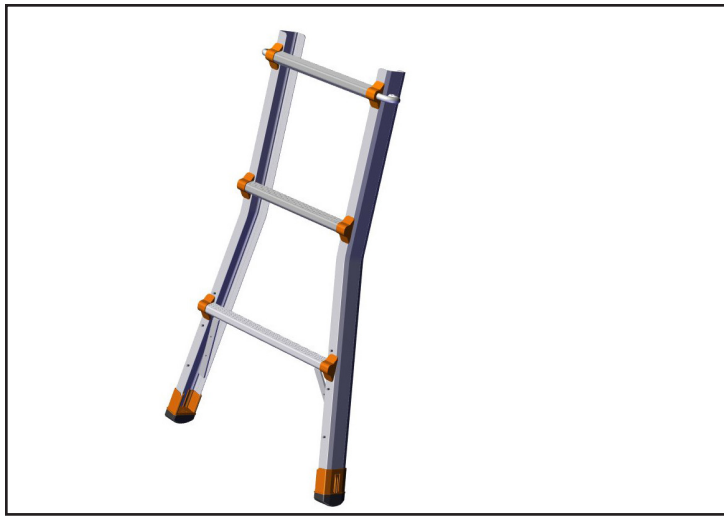

9. Make sure that the rung cap and lock tab are secure before re-installing the outer assembly onto the inner assembly.



10. Re-insert the outer assembly onto the inner assembly. Make sure all components are secure and working properly before returning ladder to service.